

Courses up the River from the
Black Oak to the Birch

1. S. 57° E. 18⁷⁰s.
2. East 14⁷⁰s.
3. S. 68° E. 40⁷⁰s.
4. S. 67° E. 37⁷⁰s.

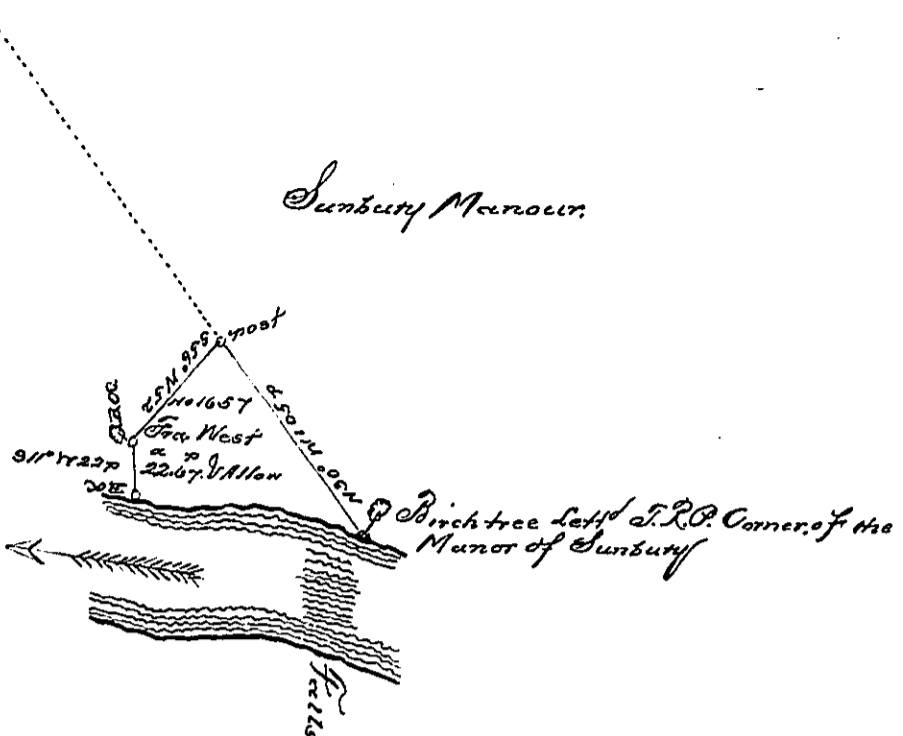

A Draught of a Tract of Land called Wests Fishingplace. Situate on the West Side of the North East branch of Susquehanna River, adjoining the Lower end of the Proprietaries Manour of Sunbury and opposite the Falls in said River in Northampton County containing twenty two Acres & sixty seven perches, besides the usual allowance of 6% Cent for highways. Surveyed 14th June 1771 for Francis West. In Pursuance of an order dated 3rd April 1769 No. 1657.

by me

Chas. Stewart. Dep. Secy

To
John Lukens Esq^r
Survey^r Gen^l

IN TESTIMONY that the above is a copy of the original remaining on file in the Department of Internal Affairs of Pennsylvania, made conformably to an Act of Assembly approved the 16th day of February, 1833, I have hereunto set my Hand and caused the Seal of said Department to be affixed at Harrisburg, this

first day of April, 1895,

Roac P. Proctor

Secretary of Internal Affairs.